

RECOMMENDED MOUNTING HOLE Ø		
Limit	Inch	mm
MIN	1.3750	34.9250
MAX	1.3755	34.9377

- NOTES:
- BUSHING IS IMPREGNATED WITH CARTER STANDARD NEVERLUBE LUBRICANT.
 - ALL EXPOSED SURFACES HAVE BLACK OXIDE.
 - CUSTOM LASER ETCHING IS AVAILABLE UPON REQUEST.

MAXIMUM CLAMPING TORQUE**	
Inch lbf	Nm
2,100	237

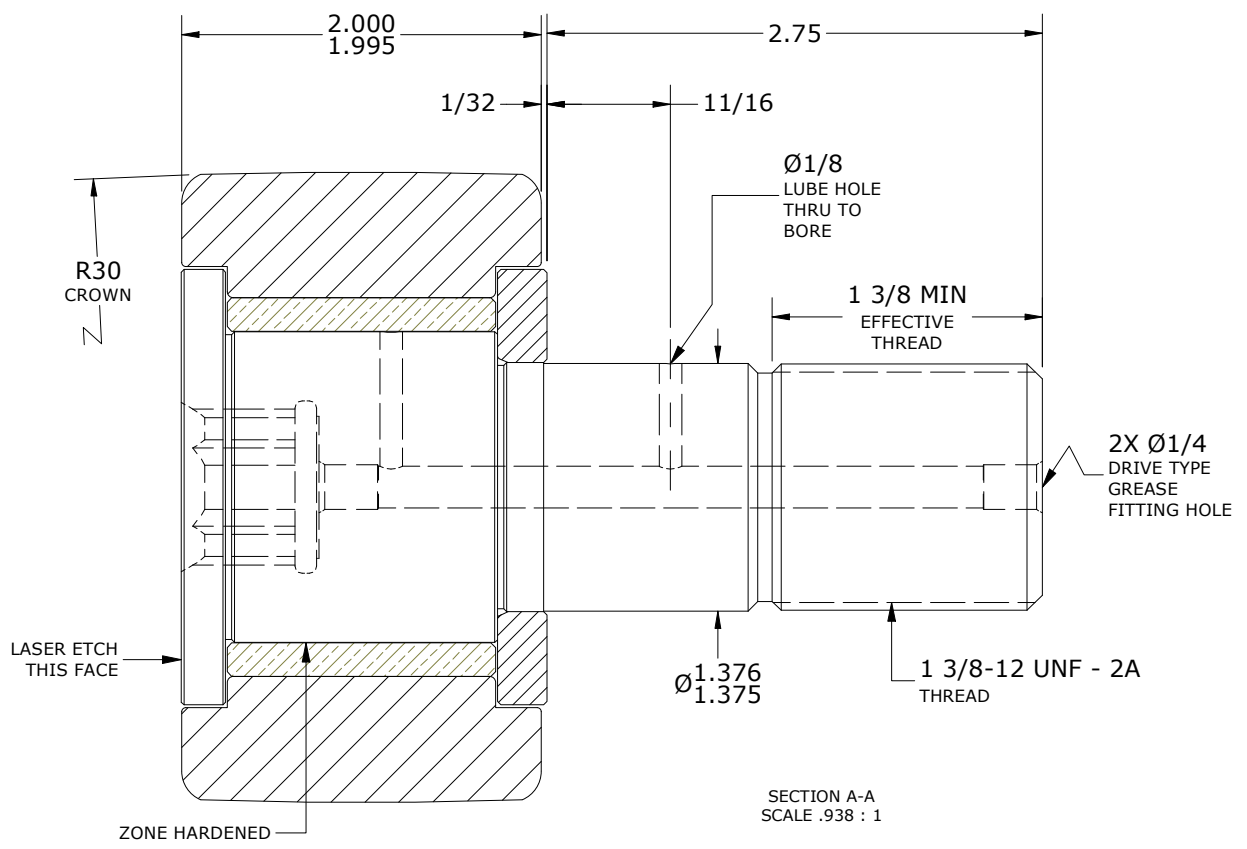
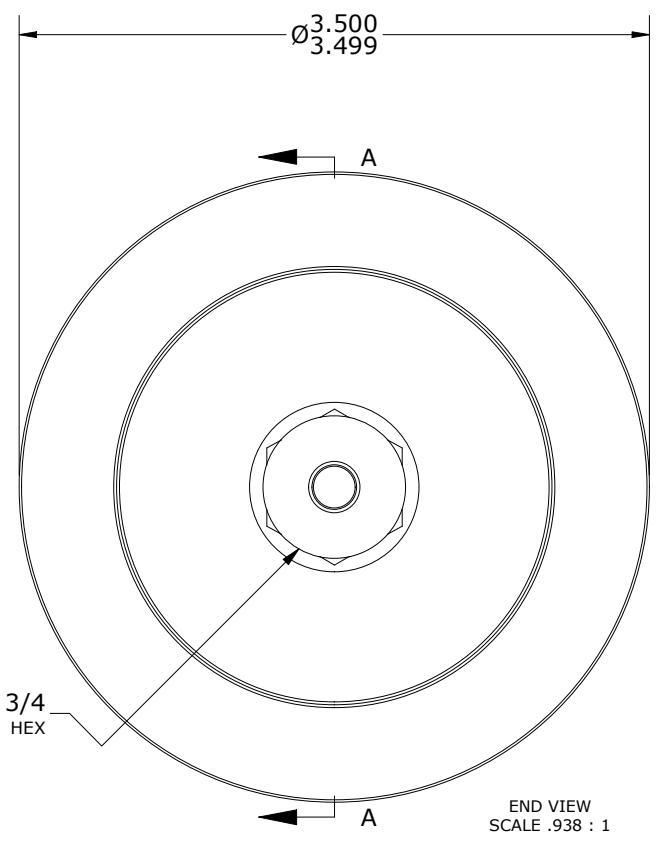
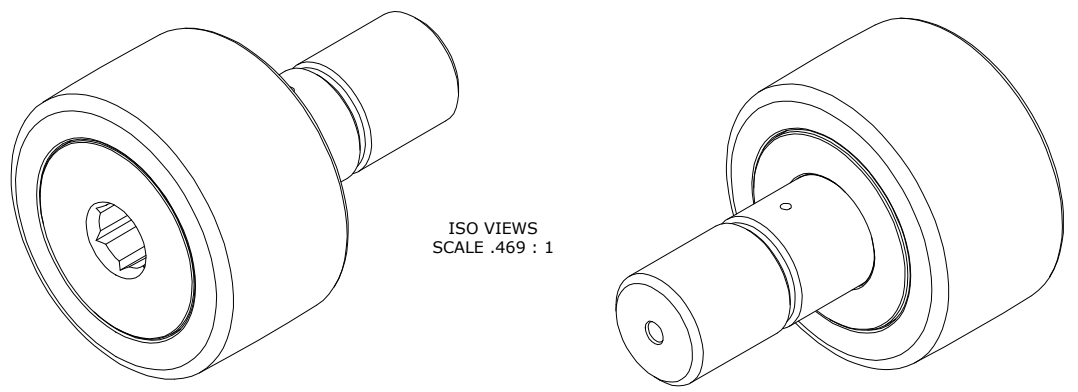

**TORQUE SPECIFICATION IS BASED ON LUBRICATED THREADS, IF USING DRY THREADS DOUBLE TORQUE VALUE

MATERIAL NOTES:

OUTER RING - BEARING STEEL, HEAT TREATED
 STUD - BEARING STEEL, ZONE HARDENED
 WASHER - STEEL, HEAT TREATED
 BUSHING - SINTERED BRONZE

CUSTOMER PART#	XX = ± .01 XXX = ± .005 XXXX = ± .0005 ANGLES = ± 1' INCH [METRIC] FRACTION = ± 1/32
ENGINEERING CHANGE ORDER NOTE	
A	
REVISION BY	DATE
SGW	6/10/2021

CARTER MANUFACTURING IS NOT RESPONSIBLE FOR TYPOGRAPHICAL ERRORS				CARTER MANUFACTURING CO., INC. GRAND HAVEN, MICHIGAN 49417			
REVISION				PART NAME: ASSEMBLY		PRODUCT TYPE: SFH	
A	AUTHOR BY HG	DRAWN BY SGW	CHK'D BY MD	SALES NC	MATERIAL NOTED		
REVISION BY	DATE	DATE	DATE	DATE	SHEET		
SGW	6/10/2021	6/10/2021	6/10/2021	6/11/2021	1 OF 2		