

LOAD RATINGS		
RATING	lbf	Newtons
RADIAL BASIC DYNAMIC	33,290	148,081
STATIC THRUST LOAD	32,500	144,567
MAXIMUM STATIC CAPACITY	51,900	230,863

- NOTES:
1. BEARING IS PACKED WITH NLGI GRADE 2, LITHIUM BASED GREASE (UNLESS OTHERWISE SPECIFIED)
  2. ALL EXPOSED SURFACES HAVE BLACK OXIDE
  3. CUSTOM LASER ETCHING IS AVAILABLE UPON REQUEST

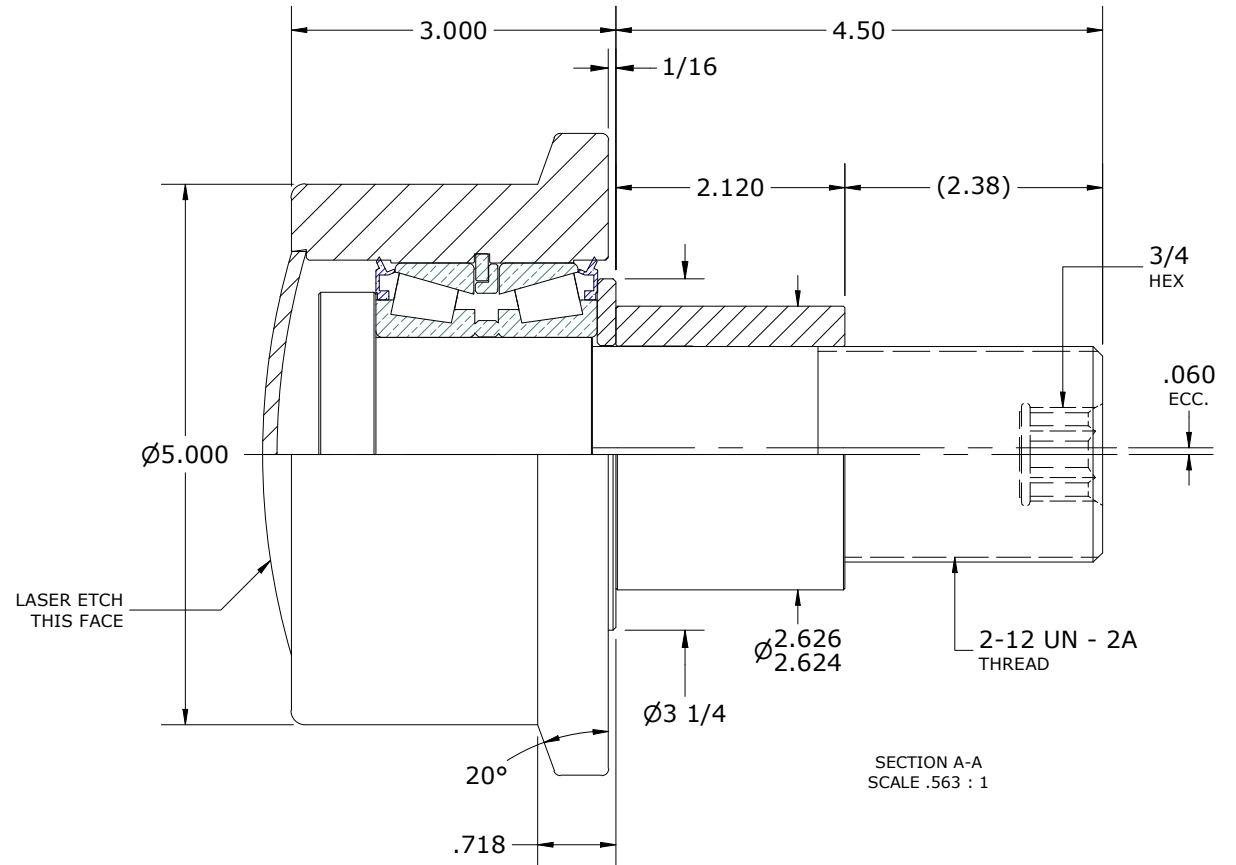
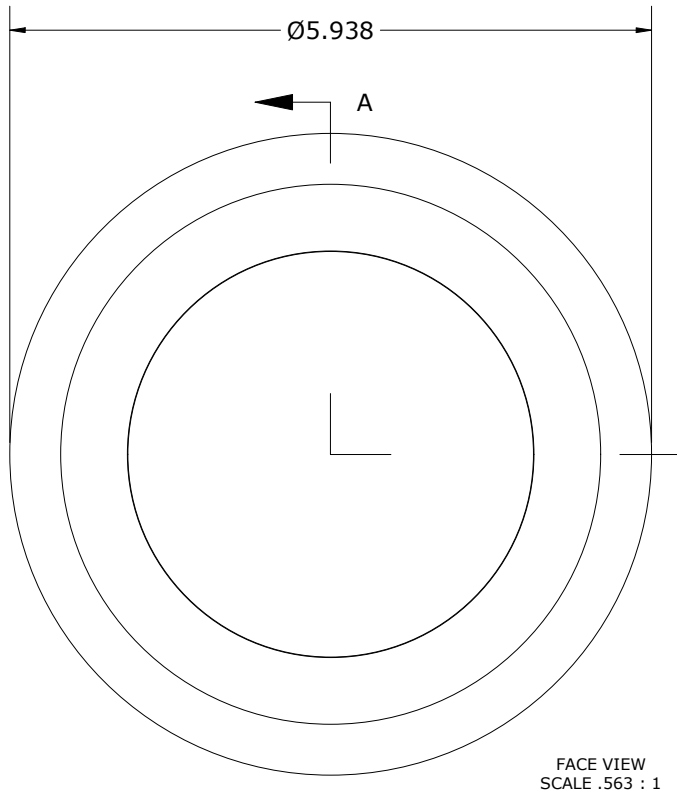
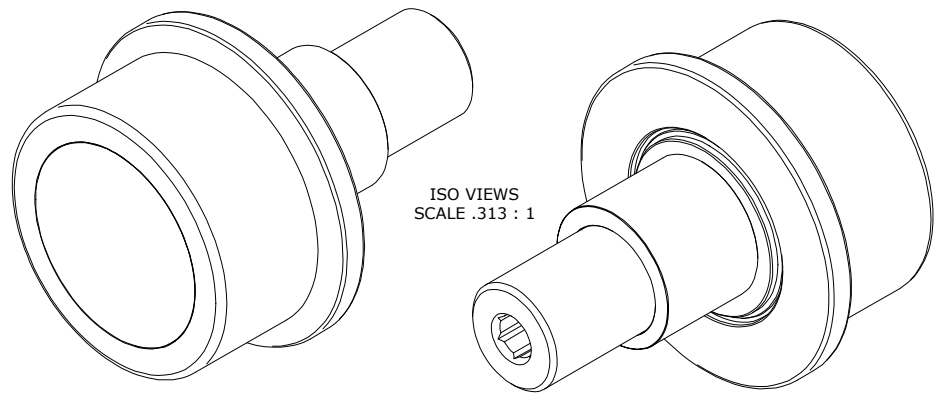

MATERIAL NOTES:

- OUTER ROLLER HOUSING- BEARING STEEL, HEAT TREATED
- STUD - STEEL
- WASHER - STEEL
- END CAP - STEEL
- TAPERED SET - TIMKEN P/N: JLM-506489-30 OR EQUIVALENT
- SEAL(S) - SYNTHETIC
- ECCENTRIC SLEEVE - STEEL

CUSTOMER PART#	XX = ± .01 XXX = ± .005 XXXX = ± .0005 ANGLES = ± 2' INCH [METRIC] FRACTION = ± 1/64
<b>ENGINEERING CHANGE ORDER NOTE</b>	
CARTER STANDARD SURFACE FINISH IS MEASURED IN "Ra" UNITS UNLESS OTHERWISE SPECIFIED.	

CARTER MANUFACTURING IS NOT RESPONSIBLE FOR TYPOGRAPHICAL ERRORS				<b>CARTER MANUFACTURING CO., INC.</b> GRAND HAVEN, MICHIGAN 49417			
<b>REVISION</b>				PART NAME: ASSEMBLY		PRODUCT TYPE: Hi-Rollers™	
<b>B</b>	AUTHOR BY HG	DRAWN BY SGW	CHK'D BY MD	SALES NC	MATERIAL NOTED		
REVISION BY DJB	DATE 2/22/2024	DATE 4/9/2019	DATE 2/21/2024	DATE 4/9/2019	SHEET 1 OF 2		